



RF Remote Controller - Black

WR-8114-RC-W



LIVE SIMPLE
LIVE SMART

Description

Wretro RF Remote control is a sleek device with elegant design meant for your classic house. Control lights, fan curtain and much more through Wretro Remote. The remote works on RF technology so it doesn't need to be directed towards the appliance for its operation and can work within the range of 50 meters.

Main Features

- 1) Sleek Design.
- 2) Works on RF Technology.
- 3) 50 Meter Range.
- 4) Dimmer Keys (Adjusting the brightness of terminal nodes.)
- 5) ON-OFF State Indicator (All on and all off buttons)

Installation of Remote Control - Battery

Remote control battery box is equipped with a new battery, you can use it as long as you remove the protective film of the battery.

If you find the indicator dimmed and the remote control RF range shorten, please replace the battery with a new Li-Mn button cell which type for CR2450.

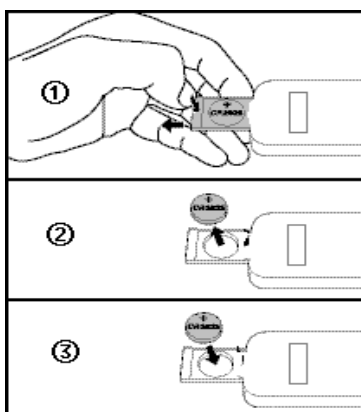

Method for replacing the battery:

1. Press the catching groove of remote control and battery box, then pull out the battery box.
2. Put into a type CR2450 Li-Mn button cell.
3. Push the battery box into remote control and fasten it.

This remote control is comprised of indicators and 7 types of keys:

- ① **Busy Indicator** (Indicator flickers, indicating the remote control is busy in processing, transmitting or receiving data.)
- ② **ON-OFF State Indicator** (Showing the on-off state of the remote controlled terminal nodes. When the light is on, it means that the current state of terminal node is on; When the light is off, then the current state of terminal is off.)
- ③ **Setup Key** (Being used for binding and unbinding the remote control with the remote-controlled terminal nodes.)
- ④ **Scene Keys** (6 keys included, one key controls the combinational on-off state of multiple terminal nodes.)
- ⑤ **Single Keys** (30 keys included, one key controls the on-off state of single terminal node.)
- ⑥ **Dimmer Keys** (Adjusting the brightness of terminal nodes.)

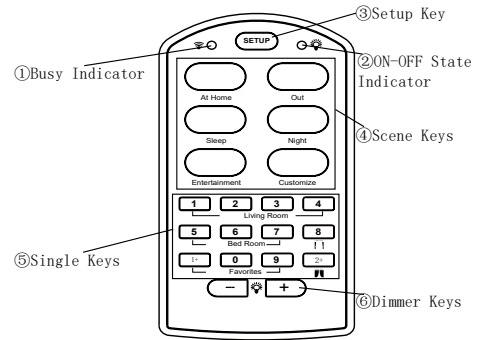

WR-8114-RC-W

Technical Parameters

Power Supply	3VDC, one piece CR2450 Li-Mn button cell
Standby Current	≤5uA
Wireless Operating Frequency	433MHz
Wireless Transmit Power	~10dbm
Wireless Receiving Sensitivity	≤-105dbm
RF Control Range	about 30m indoor, about 100m outdoor.
Maximum Quantity of Controllable Devices	32
Operating Temperature	0-60°C
Relative Humidity	≤80% (Non- condensing)
Dimension(L* W * H)	99mm * 52mm * 12mm
Weight	38~45g